

LED line PRIME

Code: 210486

EAN: 5905378210486

Track light LUMICANTO 14-29W CCT 36/60° black PRIME



Track light LUMICAANTO 14-29W CCT 36/60° in black is an advanced LED line PRIME lighting setting that is characterized by high energy efficiency. Thanks to the BRIDGELUX COB LED technology and the Ra colour reproduction factor of 90, it provides clear and natural colours. The light angle of 36/60° allows precise light flow control.



Technical data

Parameter	Value
Energy efficiency class 2019/2015	E
Warranty	5
Power	• 14-29 W
Voltage	• 220-240 V AC
Correlated colour temperature	• 3000 K • 4000 K • 6000 K
Colour of the light	White
Colour rendering index Ra	90
IP protection rating	IP20
IK protection rating	06
IEC protection class	II
Luminous efficacy	do 115 lm/W
Luminous flux	1440 - 3200 lm
The lumen maintenance factor	96
Lifetime L70B50	50 000 h
Survival factor	0,9
Colour consistency in McAdam ellipses	≤3

Parameter	Value
Mounting type	3 phase rail
Frequency of the supply voltage	50/60Hz
Fixture's diameter	77 mm
Beam angle	60/36
LED type	COB - BRIDGELUX
LED quantity	1
Lifespan	50 000 h
Power Factor	0,9
Number of on/off cycles	25000
Lamp's warm-up time to 60%	1
Ambient temperature suitable for operation	5÷40
For indoor use	Inside
Colour	Black
Material (housing)	Aluminium
Material (cover)	clear glass

LED line PRIME

Code: 210486

EAN: 5905378210486

**Track light LUMICANTO 14-29W CCT
36/60° black PRIME**

Technical drawing

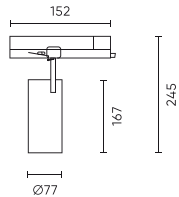

Light distribution

Additional product photos



Logistics data



Single packaging

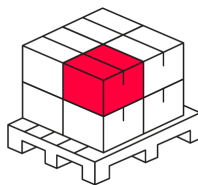

Bulk packaging

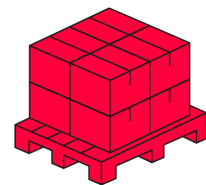

Europallet

LED line PRIME

Code: 210486

EAN: 5905378210486

**Track light LUMICANTO 14-29W CCT
36/60° black PRIME**

Example application