

LED line LITE

Code: 477057

EAN: 5907777477057

LED strip 600/5m SMD 12V 6500K 9,6W
IP65 8mm 5m 960lm/m LITE



LED 600 SMD 12V 6500K 9.6W IP65 from LED line LITE is an innovative light source that guarantees high efficiency and resistance to atmospheric conditions thanks to IP65 leak class. Includes 600 SMD 2835 diodes, it offers a brightness of as many as 480 lumens at 6500K colour temperature. The 120° lighting angle provides even illumination of space.



Technical data

Parameter	Value
Energy efficiency class 2019/2015	F
Warranty	3
Power	• 9.6 W / m
Voltage	• 12 V DC
Correlated colour temperature	• 6500 K
Colour of the light	White
Colour rendering index Ra	80
IEC protection class	III
Cutting section	2,5cm
Luminous efficacy	100
The lumen maintenance factor	96
Lifetime L70B50	30 000 h
Survival factor	0.9
Dimmable function	PWM
Colour consistency in McAdam ellipses	≤6

Parameter	Value
Wire length	200 mm
Luminous flux (lm)	960
Current (Im)	0,8
Beam angle	120
LED type	SMD 2835
LED quantity	600
Compatible dimmer type	PWM
Laminate (colour)	White
Laminate (thickness)	2
LED quantity (lm)	120
Type of adhesive tape	3M 300 LSE
Ambient temperature suitable for operation	-20÷45
Length	5000
Width	8
Height	3

LED line LITE

Code: 477057

EAN: 5907777477057

LED strip 600/5m SMD 12V 6500K 9,6W
IP65 8mm 5m 960lm/m LITE

Technical drawing

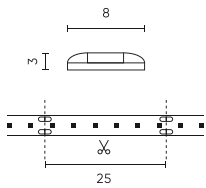

Light distribution

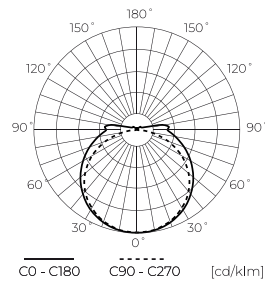

Additional product photos

Logistics data

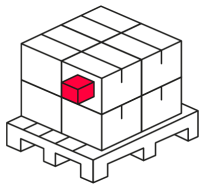

Single packaging

Quantity	5 m
Width	180 mm
Height	20 mm
Length	180 mm
Weight	0,2 kg

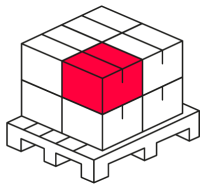

Bulk packaging

Quantity	40
Width	320 mm
Height	180 mm
Length	360 mm
Volume	0,020 m3
Weight	7,66 kg
Comments	

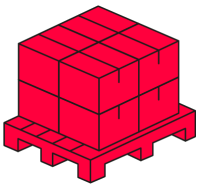

Europallet

Quantity	2400
Height	1,90 m
Quantity in layer	240
Number of layers	10
Bulk quantity	60
Weight	485 kg

LED line LITE

Code: 477057

EAN: 5907777477057

**LED strip 600/5m SMD 12V 6500K 9,6W
IP65 8mm 5m 960lm/m LITE**

Example application